

## BELT CONVEYOR QUOTATION WORKSHEET

Company \_\_\_\_\_ Date \_\_\_\_\_  
 Contact \_\_\_\_\_ Quote Due \_\_\_\_\_ Desired Delivery \_\_\_\_\_  
 Phone No. \_\_\_\_\_ Contact Email \_\_\_\_\_ State \_\_\_\_\_  
 HTC Sales Contact \_\_\_\_\_ Quote # \_\_\_\_\_  
 Quantity \_\_\_\_\_ Model Number \_\_\_\_\_

### Product Specs:

Max:  
 Width (inches): \_\_\_\_\_ Length (inches): \_\_\_\_\_  
 Height (inches): \_\_\_\_\_ Weight (lbs): \_\_\_\_\_  
 Min:  
 Width (inches): \_\_\_\_\_ Length (inches): \_\_\_\_\_  
 Height (inches): \_\_\_\_\_ Weight (lbs): \_\_\_\_\_  
 Description: \_\_\_\_\_  
 Max. Qty.: \_\_\_\_\_ Total Live Load: \_\_\_\_\_  
 Temperature \_\_\_\_\_  
 Environment: \_\_\_\_\_  
 Product: \_\_\_\_\_

### Belt:

Belt Width \_\_\_\_\_ Lace \_\_\_\_\_  
 Belt Type \_\_\_\_\_

### Conveyor Orientation:

Horizontal  Incline  Decline

A = \_\_\_\_' - \_\_\_\_" Horizontal OAL  
 B = \_\_\_\_' - \_\_\_\_" Top of Belt  
 C = \_\_\_\_' - \_\_\_\_" Top of Belt  
 D = \_\_\_\_' - \_\_\_\_" Elevation Change  
 E = \_\_\_\_' - \_\_\_\_" Nose-Over  
 F = \_\_\_\_' - \_\_\_\_" Power Infeed (Slaved)  
 G = \_\_\_\_ Deg. Approx. (Ref.)

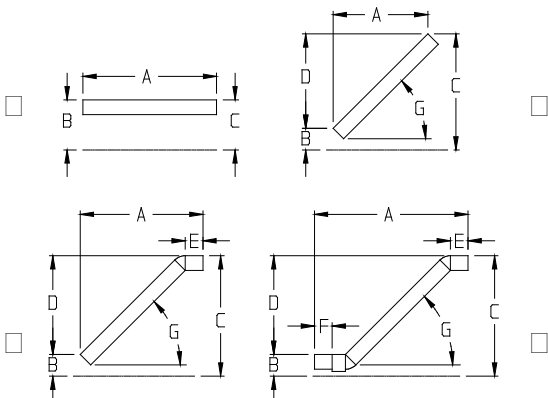

### Support Type:

Legs  Ceiling Supports  Portable  None

Approval Drawing Required:  Yes  No

### Conveyor Type:

- Slider Bed
- Roller Bed
  - 1.9 x 16 GA.  1.9 x .145 W.  2 1/2 x 11 GA.
  - Other: \_\_\_\_\_ Roller Center to Center: \_\_\_\_\_
- V-Guided
  - Cleated Height: \_\_\_\_\_ Center to Center: \_\_\_\_\_
- Trough

### Conveyor Construction:

- Welded
  - Painted  Epoxy Painted
  - Powder Coated Color RAL: \_\_\_\_\_
- Bolt-Together Galvanized

### Drive Type:

- Under Hung  Shaft Mount  Side Mount
- Over Top \_\_\_\_\_ in. Clearance
- Motorized Drive Pulley

### Drive Location:

- Discharge End  Center  Right Hand Drive
- Other \_\_\_\_\_  One Direction Product Flow
- Bi-Direction Product Flow

Customer Requested Horsepower: \_\_\_\_\_

Speed: F.P.M.: \_\_\_\_\_  Fixed  Variable (10:1 Ratio)

- AC Speed Controller  DC Speed Controller
- Mechanical Variable Speed Adjustment  None

### Plant Voltage:

- 110V Single Phase  460V Three Phase
- 220V Single Phase  208V Three Phase
- 220V Three Phase  575V Three Phase

Other: \_\_\_\_\_  
 \_\_\_\_\_  
 \_\_\_\_\_  
 \_\_\_\_\_  
 \_\_\_\_\_